

vtech[®]
Baby

Parent's Guide

Twist & Spin Lion



91-003759-001 UK

VTech understands that a child's needs and abilities change as they grow and with that in mind we develop our toys to teach and entertain at just the right level...

vtech Baby

Toys that will stimulate their interest in different textures, sounds and colours

I am...

...responding to colours, sounds and textures

...understanding cause and effect

...learning to touch, reach, grasp, sit-up, crawl and toddle

Birth-36 months



Pre-School

Interactive toys to develop their imagination and encourage language development

I want...

...to get ready for school by starting to learn the alphabet and counting

...my learning to be as fun, easy and exciting as can be

...to show my creativity with drawing and music so my whole brain develops

3-6 years



Electronic Learning Computers

Cool, aspirational and inspiring computers for curriculum related learning

I need...

...challenging activities that can keep pace with my growing mind

...intelligent technology that adapts to my level of learning

...National Curriculum based content to support what I'm learning at school

4-10 years



To learn more about this and other VTech® products, visit www.vtech.co.uk

INTRODUCTION

Twist and spin with this adorable Lion toy by **VTech**®! The Lion is designed to securely stick to high chairs and other surfaces via the suction cup located underneath it, so your little one can play without risk of knocking the Lion over the edge!

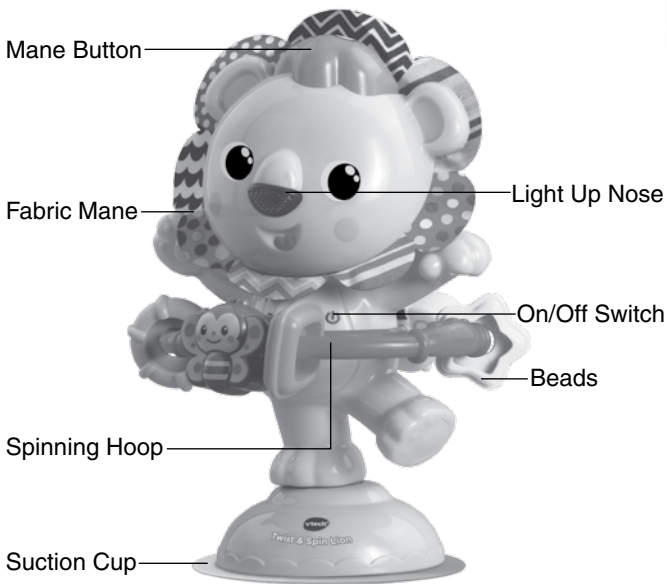

INCLUDED IN THIS PACKAGE

- One **Twist & Spin Lion**
- One Parent's Guide

WARNING:

All packing materials, such as tape, plastic sheets, packaging locks, removable tags, cable ties and packaging screws are not part of this toy and should be discarded for your child's safety.

NOTE:

Please keep this Parent's Guide as it contains important information.

GETTING STARTED

Battery Removal and Installation

1. Make sure the unit is turned **Off**.
2. Locate the battery cover on the back of the lion's head. Use a screwdriver to loosen the screw and open the battery cover.
3. Remove old batteries by pulling up on one side of each battery.
4. Install 2 new AAA (AM-4/LR03) batteries following the diagram inside the battery box. (The use of new alkaline batteries is recommended for maximum performance).
5. Replace the battery cover and tighten the screw to secure.

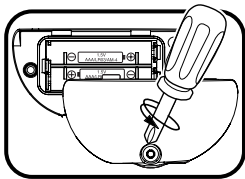

BATTERY NOTICE

- Use new alkaline batteries or fully charged NI-MH (Nickel Metal-hydride) rechargeable batteries for best performance.
- Use only batteries of the same or equivalent type as recommended.

- Do not mix different types of batteries: alkaline, standard (carbon-zinc) or rechargeable, or new and used batteries.
- Do not use damaged batteries.
- Insert batteries with the correct polarity.
- Do not short-circuit the battery terminals.
- Remove exhausted batteries from the toy.
- Remove batteries during long periods of non-use.
- Do not dispose of batteries in fire.
- Do not charge non-rechargeable batteries.
- Remove rechargeable batteries from the toy before charging (if removable).
- Rechargeable batteries are only to be charged under adult supervision.



Disposal of batteries and product

The crossed-out wheelee bin symbols on products and batteries, or on their respective packaging, indicates they must not be disposed of in domestic waste as they contain substances that can be damaging to the environment and human health.



The chemical symbols Hg, Cd or Pb, where marked, indicate that the battery contains more than the specified value of mercury (Hg), cadmium (Cd) or lead (Pb) set out in Battery Directive (2006/66/EC).

The solid bar indicates that the product was placed on the market after 13th August, 2005.

Help protect the environment by disposing of your product or batteries responsibly.

For more information, please visit:

www.recycle-more.co.uk

www.recyclenow.com

PRODUCT FEATURES

1. On/Off Switch

To turn the unit **On**, slide the **On/Off Switch** to the **On** ☺ position. You will hear a cute song, phrase and sounds. To turn the unit **Off**, slide the **On/Off Switch** to the **Off** ● position.

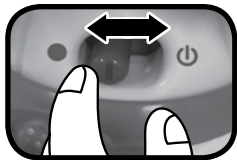

2. Suction Cup

Attach the suction cup firmly to a smooth, flat surface. For better suction, we recommend wetting the suction cup. For your child's safety, please make sure the suction cup is securely attached before allowing baby to play.

3. Automatic Shut Off

To preserve battery life, the **Twist & Spin Lion** will automatically power down after approximately 60 seconds without input. The unit can be turned on again by pressing the **Mane Button**.

Note:

If the unit repeatedly powers down while playing, or the light up nose fades out, we suggest changing the batteries.

ACTIVITIES

1. Mane Button

Press the **Mane Button** to hear playful phrases, short tunes, fun sounds, songs and melodies. When a melody or a song is playing, spin the hoop to hear fun sounds added to the melody or song. The **Light Up Nose** will flash with the sounds.



2. Spinning Hoop

Spin the **Spinning Hoop** to activate the hoop sensor and hear fun sounds and short tunes. The **Light Up Nose** will flash with the sounds.

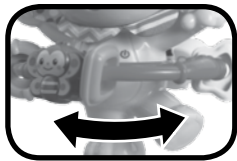

MELODY LIST

1. Rockin' Robin
2. Little Bitty Pretty One
3. Looby Loo
4. Turkey in the Straw
5. Skip to my Lou
6. Toyland
7. Yankee Doodle
8. Goodnight Ladies
9. Pat-a-Cake
10. Muffin Man
11. Ring Around A Rosy
12. One Man Went to Mow a Meadow
13. Hickory, Dickory, Dock
14. I'll Give You a Paper of Pins
15. Chicken Reel

SING-ALONG SONG LYRICS

Song 1

Twist, twirl, spin around,
I love to spin my hoop!
Twisting, twirling, spinning, turning,
Shake and move with me!

Song 2

In the jungle,
I love to shake,
Playing with my favourite hoop Is really great!

Song 3

I'm a cute and playful lion,
I am the king of the jungle.
I am strong and have a big mane,
And I roar when I'm happy!

CARE & MAINTENANCE

1. Keep the unit clean by wiping it with a slightly damp cloth.
2. Keep the unit out of direct sunlight and away from any direct heat sources.
3. Remove the batteries if the unit will not be in use for an extended period of time.
4. Do not drop the unit on hard surfaces and do not expose the unit to moisture or water.

TROUBLESHOOTING

If for some reason the program or activity stops working or malfunctions, please follow these steps:

1. Please turn the unit **Off**.
2. Interrupt the power supply by removing the batteries.
3. Let the unit stand for a few minutes, then replace the batteries.
4. Turn the unit **On**. The unit should now be ready to play with again.
5. If the unit still does not work, install a new set of batteries.

If the problem persists, please contact our Consumer Services Department and a service representative will be happy to help you.



CLASS 1
LED PRODUCT

CONSUMER SERVICES

Creating and developing **VTech**[®] products is accompanied by a responsibility that we at **VTech**[®] take very seriously. We make every effort to ensure the accuracy of the information, which forms the value of our products. However, errors sometimes can occur. It is important for you to know that we stand behind our products and encourage you to call our Consumer Services Department with any problems and/or suggestions that you might have. A service representative will be happy to help you.

UK Customers:

Phone: 0330 678 0149 (from UK) or +44 330 678 0149 (outside UK)

Website: www.vtech.co.uk/support

Australian Customers:

Phone: 1800 862 155

Website: support.vtech.com.au

NZ Customers:

Phone: 0800 400 785

Website: support.vtech.com.au

PRODUCT WARRANTY/ CONSUMER GUARANTEES

UK Customers:

Read our complete warranty policy online at vtech.co.uk/warranty.

Australian Customers:

**VTECH ELECTRONICS (AUSTRALIA) PTY LIMITED –
CONSUMER GUARANTEES**

Under the Australian Consumer Law, a number of consumer guarantees apply to goods and services supplied by VTech Electronics (Australia) Pty Limited. Please refer to vtech.com.au/consumerguarantees for further information.

**Visit our website for more
information about our products,
downloads, resources and more.**

www.vtech.co.uk
www.vtech.com.au



TM & © 2019 VTech Holdings Limited.
All rights reserved.
Printed in China.
91-003759-001^{UK}